

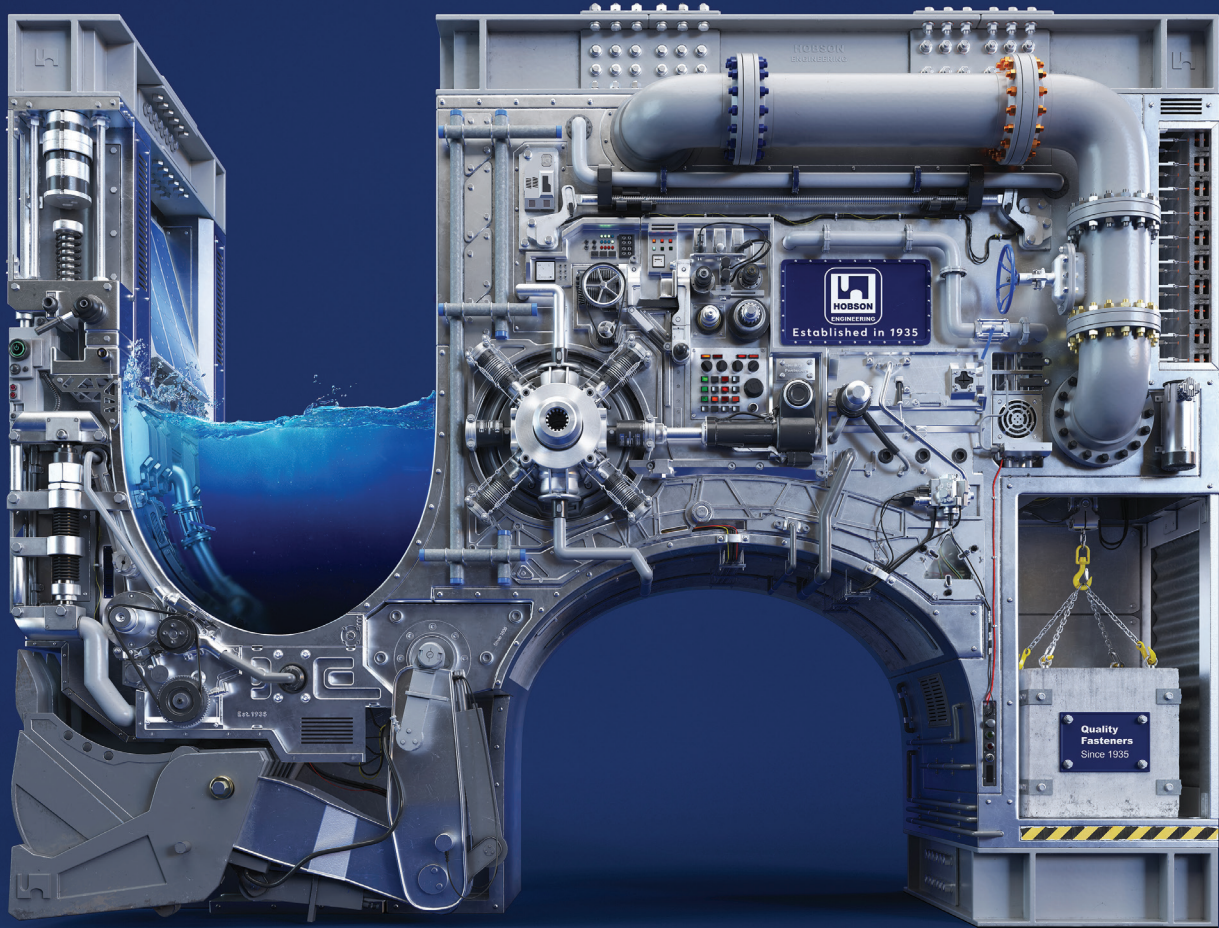

Build **Anything**



| PRODUCT **GUIDE**



























SOKO®

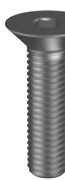

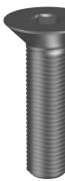
SOKO

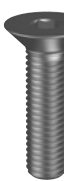

METRIC CAP SCREW SOCKET	UNC CAP SCREW SOCKET	METRIC FINE CAP SCREW SOCKET	METRIC CAP SCREW SOCKET	NEW METRIC CAP SCREW SOCKET	NEW UNC CAP SCREW SOCKET	KEY
 <p>SHSOZCM</p> <p>Z/P DIN 912 CLASS 12.9</p>	 <p>SHSOZC</p> <p>Z/P ANSI B18.3 ASTM A574</p>	 <p>SHSOZFM</p> <p>Z/P DIN 912 CLASS 12.9</p>	 <p>SHSOPCM</p> <p>PLN DIN 912 CLASS 12.9</p>	 <p>SHSOFCM</p> <p>ZFS DIN 912 CLASS 12.9</p>	 <p>SHSOFC</p> <p>ZFS ANSI B18.3 ASTM A574</p>	<p>PLN PLAIN</p> <p>Z/P ZINC PLATED (RoHS COMPLIANT)</p> <p>ZYP ZINC YELLOW PASSIVATE</p> <p>HDG HOT DIP GALVANISED</p> <p>MGAL MECHANICAL GALVANISED</p> <p>ZFS ZINC FLAKE SILVER</p> <p>ALLOY ALLOY STEEL</p>
 <p>SHSOFFM</p> <p>ZFS DIN 912 CLASS 12.9</p>	 <p>SH88ZCM</p> <p>Z/P DIN 912 CLASS 8.8</p>	 <p>SHSOP</p> <p>PLN ANSI B18.3 ASTM A574</p>	 <p>SHSOPW</p> <p>PLN BS 2470 ASTM A574</p>			
 <p>SHSOPFM</p> <p>PLN DIN 912 CLASS 12.9</p>	 <p>SHSOFF</p> <p>ZFS ANSI B18.3 ASTM A574</p>	 <p>SHSOPF</p> <p>PLN ANSI B18.3 ASTM A574</p>	 <p>SLSOPCM</p> <p>PLN DIN 7984 CLASS 010.9</p>	 <p>SLSOP</p> <p>PLN ANSI B18.3 ALLOY STEEL</p>	 <p>SLSOFCM</p> <p>ZFS DIN 7984 CLASS 010.9</p>	 <p>SCSOZC</p> <p>Z/P ANSI B18.3 ASTM F835</p>
 <p>SCSOP</p> <p>PLN ANSI B18.3 ASTM F835</p>	 <p>SCSOPC</p> <p>PLN ANSI B18.3 ASTM F835</p>	 <p>SCSOPW</p> <p>PLN BS 2470 ASTM F835</p>	 <p>SCSOPF</p> <p>PLN ANSI B18.3 ASTM F835</p>	 <p>SC10ZCM</p> <p>Z/P DIN 7991 CLASS 010.9</p>	 <p>SC10PCM</p> <p>PLN DIN 7991 CLASS 010.9</p>	 <p>SCSOFCM</p> <p>ZFS DIN 7991 CLASS 012.9</p>



<p>METRIC CSK FLAT SOCKET</p>  <p>SCSOZCM</p> <p>Z/P DIN 7991 CLASS 012.9</p>	<p>METRIC CSK FLAT SOCKET</p>  <p>SCSOPCM</p> <p>PLN DIN 7991 CLASS 012.9</p>	<p>METRIC BUTTON HEAD SOCKET</p>  <p>SBSOZCM</p> <p>Z/P ISO 7380 CLASS 012.9</p>	<p>METRIC BUTTON HEAD SOCKET</p>  <p>SBSOPCM</p> <p>PLN ISO 7380 CLASS 012.9</p>	<p>UNC BUTTON HEAD SOCKET</p>  <p>SBSOZC</p> <p>Z/P ANSI B18.3 ASTM F835</p>	<p>UNC BUTTON HEAD SOCKET</p>  <p>SBSOP</p> <p>PLN ANSI B18.3 ASTM F835</p>	<p>UNF BUTTON HEAD SOCKET</p>  <p>SBSOPF</p> <p>PLN ANSI B18.3 ASTM F835</p>
<p>NEW METRIC BUTTON HEAD SOCKET</p>  <p>SBSOFCM</p> <p>ZFS ISO 7380 CLASS 012.9</p>	<p>BSW BUTTON HEAD SOCKET</p>  <p>SBSOPW</p> <p>PLN BS 2470 ALLOY STEEL</p>	<p>METRIC BUTTON HEAD SOCKET</p>  <p>SB10ZCM</p> <p>Z/P ISO 7380 CLASS 010.9</p>	<p>NEW METRIC BUTTON HEAD SOCKET</p>  <p>SB10PCM</p> <p>PLN ISO 7380 CLASS 010.9</p>	<p>METRIC BUTTON HEAD SOCKET</p>  <p>SB88ZCM</p> <p>Z/P ISO 7380 CLASS 08.8</p>	<p>METRIC PLAIN PNT SOCKET</p>  <p>SSSPPCM</p> <p>PLN ISO 4029 ALLOY STEEL</p>	<p>METRIC KNURL CUP PNT SOCKET</p>  <p>SSSKZCM</p> <p>Z/P ISO 4029 ALLOY STEEL</p>
<p>METRIC KNURL CUP PNT SOCKET</p>  <p>SSSKPCM</p> <p>PLN ISO 4029 ALLOY STEEL</p>	<p>NEW UNC KNURL CUP PNT SOCKET</p>  <p>SSSKFCM</p> <p>ZFS ISO 4029 ALLOY STEEL</p>	<p>METRIC DOG PNT SOCKET</p>  <p>SSSDPCM</p> <p>PLN DIN 915 ALLOY STEEL</p>	<p>UNC PLAIN PNT SOCKET</p>  <p>SSSPPC</p> <p>PLN ANSI B18.3 ASTM F912</p>	<p>UNC KNURL CUP PNT SOCKET</p>  <p>SSSKP</p> <p>PLN ANSI B18.3 ASTM F912</p>	<p>UNC KNURL CUP PNT SOCKET</p>  <p>SSSKPC</p> <p>PLN ANSI B18.3 ASTM F912</p>	<p>BSW KNURL CUP PNT SOCKET</p>  <p>SSSKPW</p> <p>PLN BS 2470 ALLOY STEEL</p>
<p>UNF KNURL CUP PNT SOCKET</p>  <p>SSSKPF</p> <p>PLN ANSI B18.3 ASTM F912</p>	<p>UNF PLAIN PNT SOCKET</p>  <p>SSSPPF</p> <p>PLN ANSI B18.3 ASTM F912</p>	<p>UNC SHOULDER SOCKET</p>  <p>SOSOPC</p> <p>PLN ANSI B18.3 ALLOY STEEL</p>	<p>METRIC SHOULDER SOCKET</p>  <p>SOSOPCM</p> <p>PLN ISO 7379 CLASS 012.9</p>	<p>BSW SHOULDER SOCKET</p>  <p>SOSOPW</p> <p>PLN BS 2470 ALLOY STEEL</p>	<p>METRIC HEX NUT</p>  <p>NH12PCM</p> <p>PLN AS1112.1 CLASS 12</p>	

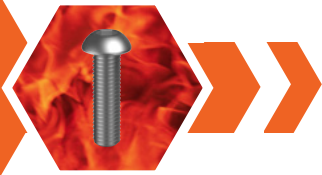

METRIC T-BOLT

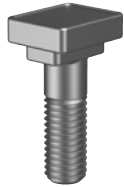

BTSOPCM

PLN
HEC
CLASS 10.9

BSW T-BOLT

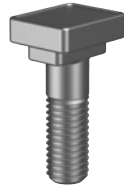

BTSOPW

PLN
HEC
CLASS 10.9

BSP PRESSURE PLUG HEX

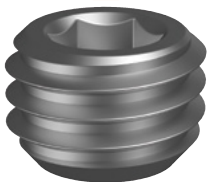

PPSOPB

PLN
ALLOY STEEL

Dowel Pin

CHAMFERED ENDS for easy insertion into pre-drilled hole.

NEW DOWEL PIN



PDSOPM

PLN
DIN 6325 M6
ALLOY STEEL

S-LOK SPRING PIN



PLSOZ

Z/P
HEC

NEW S-LOK SPRING PIN



QPLSOB

BLACK OXIDE
ISO 8752

Marking symbols for fasteners with reduced loadability



Fasteners with reduced loadability possess material properties according to the appropriate standard. However, geometry inhibits them from achieving full tensile capacity.



Countersunk (Flat), Buttonhead and Low Head Socket cap screw have reduced loadability as the stress area in the head is smaller than that in the threads.

The head markings of fasteners with reduced loadability are prefixed with a '0'.

Property Class	8.8	10.9	12.9
Marking	08.8	010.9	012.9



HIGH TENSILE



STAINLESS HARDWARE



SCHNORR®



MATERIAL HANDLING



STRUCTURAL



STAINLESS FASTENERS



WASHERS



TRADE PAX™



SOKO®



NEPTUNE®



NYLON®



MUNGO®



EARTHMOVING



BUMAX®



COMMERCIAL



CONXTRACT®



PETRO-CHEMICAL



NORD-LOCK®



LOW TENSILE



DRILLX®



1/26 Ernest Clark Road,
Canning Vale, WA 6155

t. (08) 9457 5444

e. sales@searlefasteners.com.au

searlefasteners.com.au